



ARCHITECTURAL HARDWOOD DECKING, CLADDING & CEILING SYSTEMS

# METROplank™

CONCEALED FIXED  
TIMBER DECKING



1800 894 400  
info@mortlock.com.au  
www.mortlock.com.au



## THE SYSTEM

---

**Metroplank™** concealed fixed decking has been continuously refined over more than 20 years of project experience. The board profile and clip system are engineered to allow controlled, natural timber movement, ensuring long-term stability and performance.

**Metroplank™** is built to last and has been used in both commercial high traffic areas as well as luxury residential homes in some of Australia's most high-profile suburbs.



# METROPLANK PROFILE & SIZES



## METROPLANK PROFILE & SIZES

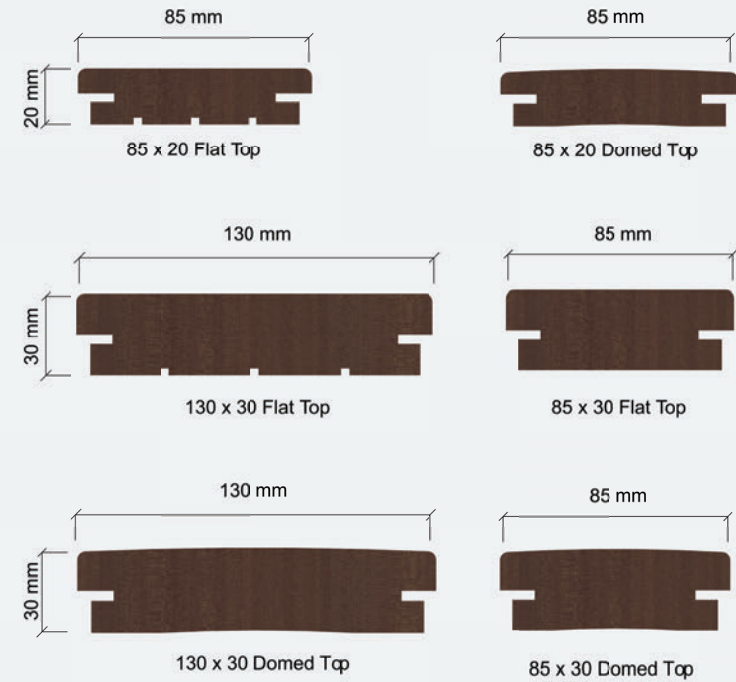

**Metroplank™** is available in flat and domed top profiles. Flat top boards are generally recommended for covered or low-exposure areas. For fully exposed applications the 85x20mm or 85x30mm domed profiles are recommended as they improve water runoff, reduce surface moisture retention, and increase long-term stability.



## TIMBER SPECIES & PRICING

Note: 130x20 is only available in Pacific Teak



BLACKBUTT	
Sizes Available	85×20
Recommended Use	Residential Applications



SPOTTED GUM	
Sizes Available	85×20
Recommended Use	Residential & Commercial Applications

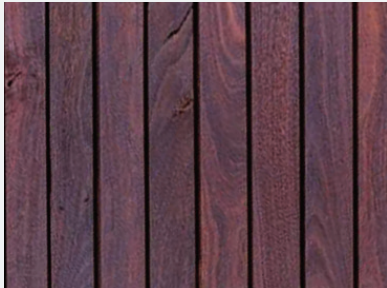

JARRAH	
Sizes Available	85×20, 85×30, 130×30
Recommended Use	Residential & Commercial Applications



IRONBARK	
Sizes Available	85×20
Recommended Use	Residential & Commercial Applications

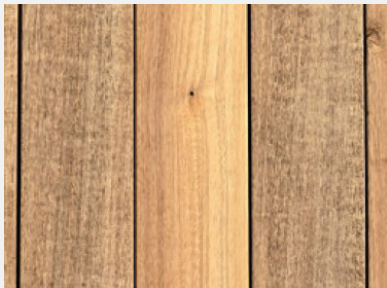

PACIFIC TEAK	
Sizes Available	85×20, 130×20*
Recommended Use	Residential & Commercial Applications

## TIMBER SPECIES DATA

TIMBER SPECIES	BAL RATING	LENGTHS*	MOVEMENT**
Blackbutt	BAL 12.5, 19 & 29	Average Length 2.4m	High - 7.3%
Jarrah	BAL 12.5 & 19	Average Length 2.1m	High - 7%
Pacific Teak	BAL 12.5 & 19	Average Length 2.7m	Low - 4%
Spotted Gum	BAL 12.5, 19 & 29	Average Length 2.7m	Medium - 6.5%
Ironbark	BAL 12.5, 19 & 29	Average Length 2.7m	Medium - 6.1%

\* Lengths supplied range from 0.9-4.2m+ with 90% of boards 1.8m and above. Higher average means more longer length boards.

\*\* Stability of the timber, shrinkage across the board width.





## FINISHING

Timber can be supplied uncoated or factory pre-oiled. Mortlock Timber uses Cutek CD50 penetrating oil for all pre-oiled boards.

To maintain the natural colour of the timber, a Cutek Colourtone is recommended.

Pre-oiled boards receive one factory coat. A second coat must be applied on-site after installation. Further maintenance requirements are outlined in the Maintenance section of this document.

For additional information on Cutek oils and Colourtones, visit [www.cutek.com.au](http://www.cutek.com.au)

## SPECIFICATION

### EXAMPLE SPECIFICATION

EXAMPLE SPECIFICATION	
Product Name	Metroplank Timber Decking System
Timber Species	Spotted Gum
Finish	Cutek CD50 Clear Oil
Board Size & Shape	85×20 Domed Surface
Fire Requirements	BAL 29
Contact	Mortlock Timber Group 1800 894 400 <a href="mailto:info@mortlock.com.au">info@mortlock.com.au</a> <a href="http://www.mortlock.com.au">www.mortlock.com.au</a>





## PRICING & TENDER SUBMISSION

To make large scale projects and tenders easier, we are able measure from PDF drawings which are returned with a detailed BOQ and an itemised proposal for cross referencing. Email plans or Tender invite to [info@mortlock.com.au](mailto:info@mortlock.com.au)



## IMPORTANT INFORMATION

---

### UNEVEN WEATHERING

If timber is stored in direct sunlight prior to installation, uneven weathering may occur. Plastic wrapping does not provide full UV protection, some boards may change colour at different rates. After installation, allow the decking to weather naturally for a few months and the colour will even out over time. Boards installed in shaded areas will weather more slowly than timber exposed to full sun.

### MINIMUM GROUND HEIGHT

We recommend timber decking to have a minimum 300mm ground clearance, so timber can breathe and allow moisture to escape.

### EXPANSION ALLOWANCE

Timber is a porous material and some movement should be expected. Metroplank is designed to have a 5mm spacing between the boards to allow for natural expansion.

### DRAINAGE

Enough drainage must be allowed underneath timber decking. If water is not able to drain or flow away from the timber it will expand beyond normal expectations and cup.

### ONSITE STORAGE

The decking should be kept in its original pack until installation. If it is repacked, it should be done the same as it was when delivered and must be stored out of the weather and at least 50mm off the ground.

### TIMBER MOVEMENT

Considering the effects of the harsh Australian climate, from heavy monsoonal rains to areas with extremely hot and dry summers you can only expect timber to move. If timber shrinks or expands slightly this is completely normal. Mortlock Timber cannot be held liable for timber that isn't maintained or in prolonged contact with moisture. This will cause timber to move beyond normal expectations.

### TANNIN LEACHING

Tannins are natural extractives present in most timbers, some more than others. Moisture permeating through the timber will bring these tannins to the surface which can cause stains on surrounding materials such as paving or rendered walls. Levels of tannin leaching will reduce over time and if staining does occur it should be scrubbed off as soon as possible using a stiff bristled broom and soapy water.

## INSTALLATION NOTES

Subframes for your decking (not supplied by Mortlock Timber) must be built to the relevant building regulations in your area. Tops of joists should have a joist flashing or be painted black.

Joists to be set at 450mm centres for 20mm thick decking and 600mm centres for 30mm thick decking, Metroplank can be installed on timber or steel joists. Decking should be secured with no less than an 8-gauge self-drilling fastener. Metroplank is available with 2 types of screws specially designed for the system, one for timber joists and the other for steel joists, please specify when requesting quotes and ordering.

To avoid cutting the last board to final width, consider building the subframe to a width to suit the incremental sequence of the boards. For example: 2400mm deck width. 85mm board with a 5mm spacing has a 90mm cover. Therefore  $2400 \div 90\text{mm} = 26.67$  boards.  $27 \text{ boards} \times 90\text{mm}$  is 2430mm total width. Final width =  $90 \times 27 = 2430$ .

Use a 5mm spacer to maintain a consistent gap between the end of the decking boards and adjacent walls.





# INSTALLATION

## 01 STARTING POINT & EDGE BOARDS

If the laying direction is 90 degrees to building, start at either end of your deck.

If decking is being laid parallel to a wall or building, start from the outside edge so that you have a full board on the most visible edge, and work back towards the wall. Otherwise if you have built the sub frame to suit the width of the decking board to maintain full board across the deck, start at the edge against the wall.



## 02 DECKING

The board laying sequence starts at the edge moulding and works back to the wall to maintain a full board width on the most visible edge, otherwise build a sub frame to suit the width of the decking board to maintain full board across the deck.

Once the edge board has been secured, apply firm pressure downwards on the next board. Tap in with a rubber faced mallet to engage the board firmly with the preceding row of clips.

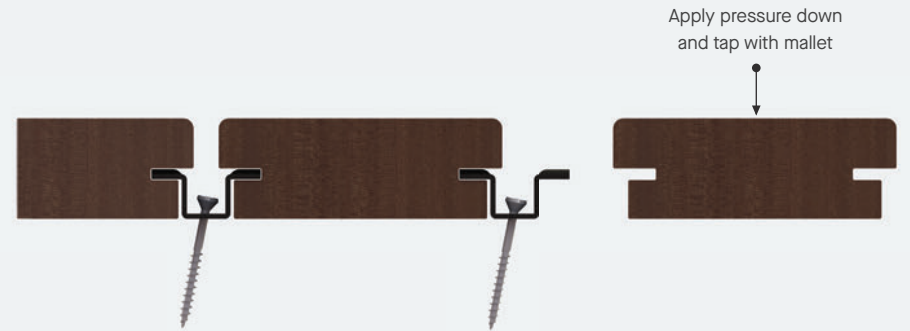

Pre-cutting and loose laying 5-10+ rows in advance is the most effective way of working. This allows you to oil the backs of the boards (pre-oiling will save oiling the back of the board) prior to laying and to see where to install double clips for butt joins in advance.

When laying over a large area, take some measurements every 5-6 rows of decking to check that the boards are keeping parallel to the edge moulding.

## 03 FASTENING CLIP

Once board is interlocking with clips fixed to the joists, slide fastening clip into groove on the exposed edge of the board till firm. Ensuring that the bottom of the clip is flush with the joist, hold clip in place and screw down. Screw should be in the centre of the clip and as close to 90 degrees to joist as possible. Screw will need to be on a slight angle to avoid damage to the edge of the decking.

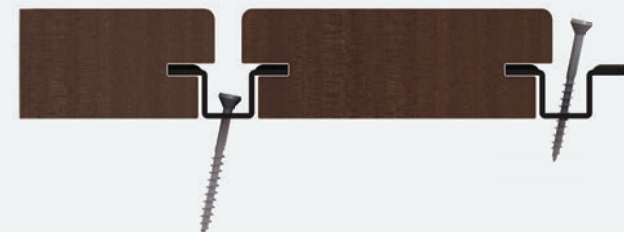



**04 BUTT JOINTING BOARDS**

Stagger the butt joints as per diagram shown. Butt joints should be centred on the joist, secured with a double clip on both sides to increase the clamping area and prevent end splitting. Joints should be staggered so the nearest joint on the same joist is 3 boards away, decking boards should span 900mm minimum for 20mm decking (connecting 3 joists at 450mm) or 1200mm for 30mm decking (connecting 3 joists at 600mm)

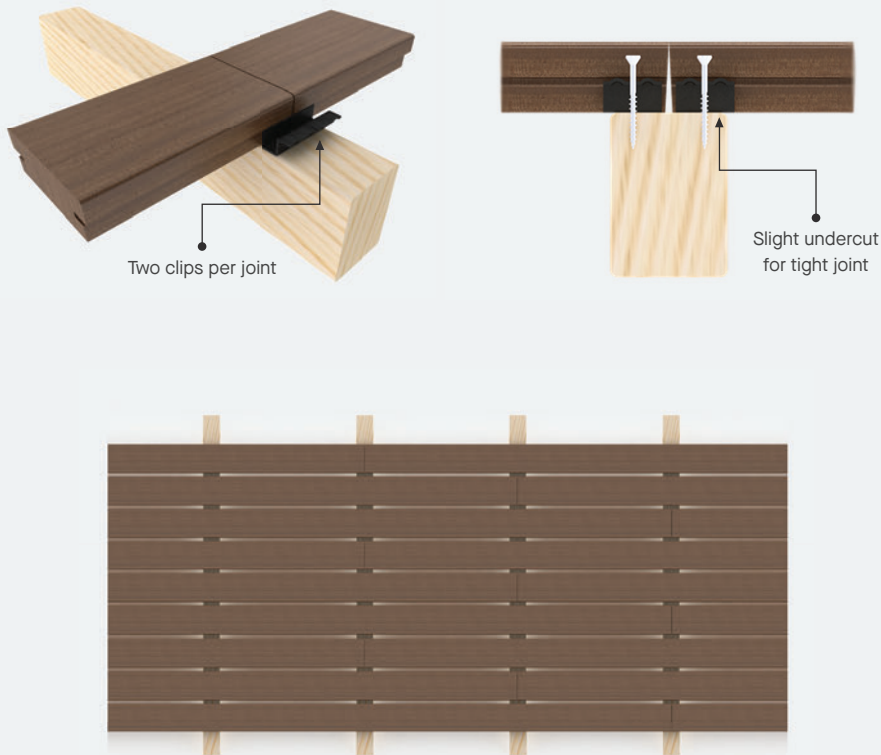



## MAINTENANCE

---

Mortlock Timber uses Cutek CD50 oil when pre-oiling. Whilst there are other products you can use, below is a recommendation for maintaining your timber decking using Cutek CD50. First coat of Cutek CD50 Clear should be applied to all surfaces of the timber prior to delivery by Mortlock Timber, with a second coat of Cutek CD50 applied once installation is complete.



Apply a second coat of Cutek CD50 with Colourtone to decking once installation is complete, to delay the silvering process and enhance the natural character and colour of the timber. Colourtone Cutek oils can still look like a clear finish, depending on the Colourtone selected. Colourtone recommendations can be found at [www.cutek.com.au/product/colourtones/](http://www.cutek.com.au/product/colourtones/)

A third coat of Cutek CD50 with Colourtone should be applied once construction is complete. A fourth coat should be applied within 6 months of third coat.

After the fourth coat, recoating time varies widely according to many factors including the age and porosity of the wood, species, situation and exposure to the weather. Typically, fully exposed decks may require coating every 1-2 years. Cutek CD50 should be reapplied when the wood is no longer beading water, or as frequently as necessary to retain the natural beauty and colour of the wood. Oil should only be applied once the previous coat has completely penetrated and is dry. The time taken for Cutek CD50 to diffuse into the timber varies significantly, depending on aspect, species, ambient temperature, porosity and moisture content of the timber.

Further information on where to buy Cutek Oil and application instructions can be found at [www.cutek.com.au](http://www.cutek.com.au)

It is not recommended that Metroplank Timber Decking is left to weather to a silver grey colour, if this look is preferred, we recommend you contact Mortlock Timber to discuss the options.



PROJECT DETAILS	
Project	Dawson Residence
Location	Coffin Bay, South Australia
Board Size	130x20
Timber Species	Pacific Teak





PROJECT DETAILS	
Project	Aria Luxury Apartments
Location	Swanborne, WA
Board Size	130x30
Timber Species	Blackbutt





PROJECT DETAILS	
Project	Ewen Street Residence
Location	Perth, WA
Board Size	85x20
Timber Species	Jarrah



PROJECT DETAILS	
Project	Hillarys Residence
Location	Hillarys, WA
Board Size	130x20
Timber Species	Pacific Teak





PROJECT DETAILS	
Project	Circe Circle
Location	Hillam Architects, MAEK Residences
Board Size	85x20
Timber Species	Blackbutt



PROJECT DETAILS	
Project	Eagle Bay Residence
Location	Eagle Bay, WA
Board Size	85x20
Timber Species	Pacific Teak

## DESIGN & INSTALLATION CONSULTING

Our team can work through detailing and specification requirements to meet specific project requirements. We can assist with budget management without compromising aesthetics and ensure our products perform with an extended life cycle.

## SAMPLES

Mortlock Timber Group samples department is stocked with our full range. We use express delivery service and generally deliver samples to your door within 2-3 days. Custom samples and sample boards can take 3-6 weeks depending on requirements.



**MORTLOCK**  
T I M B E R

W: [www.mortlock.com.au](http://www.mortlock.com.au)

T: 1800 894 400

E: [info@mortlock.com.au](mailto:info@mortlock.com.au)

---

Distribution: WA | SA | VIC | NSW | QLD | TAS